

WASTE WATER RECYCLING SYSTEM

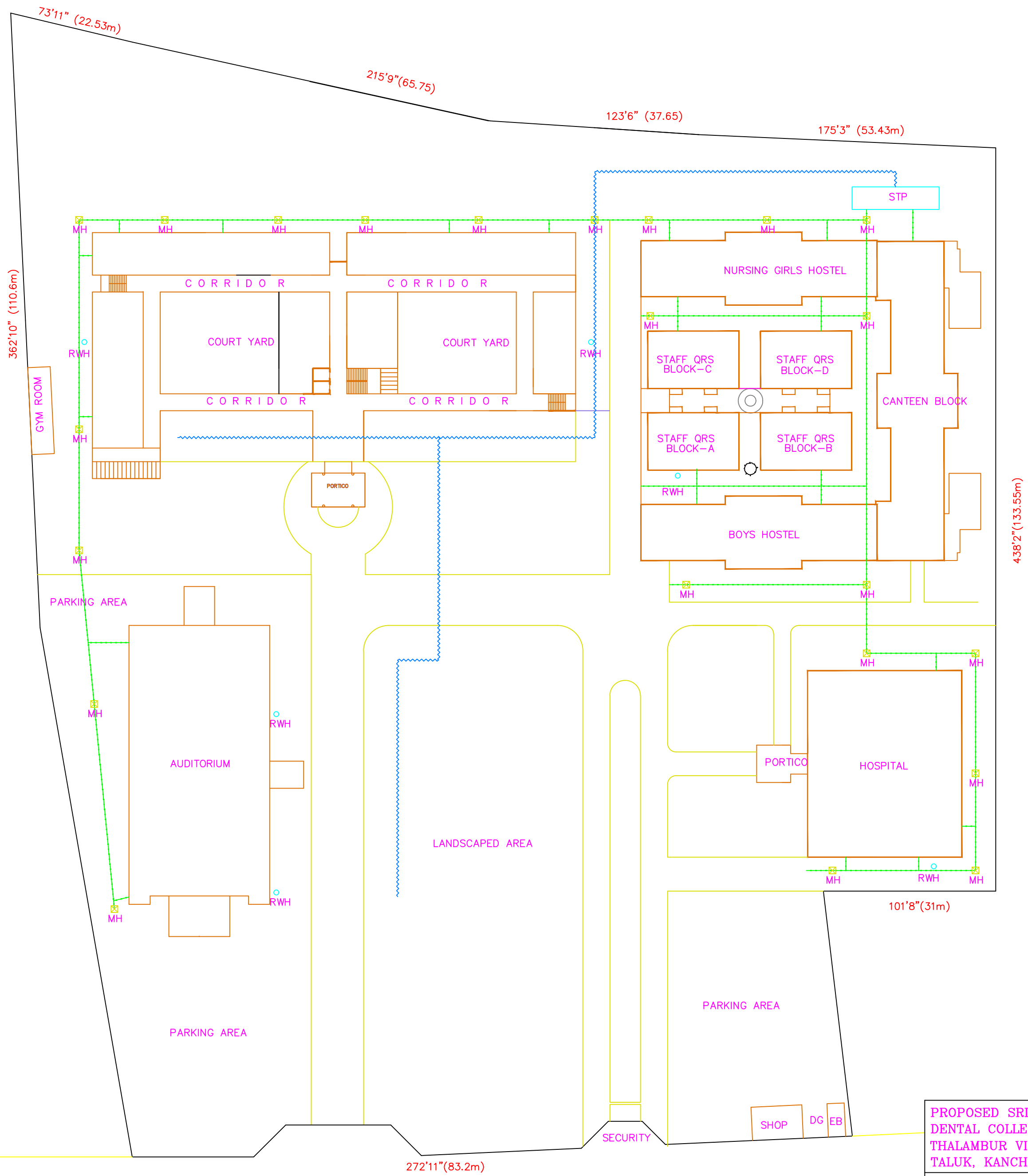



TO I.T HIGH WAY ROAD (OLD MAHALIPURAM) EXISTING ROAD



PROPOSED SRI VENKATESWARA DENTAL COLLEGE AND HOSPITAL AT THALAMBUR VILLAGE, CHENGALPET TALUK, KANCHIPURAM DIST.

DRAWING IDENTIFICATION: (S)
SITE PLAN WITH CONTOUR & LEVELS

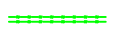
AREA DETAILS:-
 LAND AREA =

NOTES:
 1. ALL DIMENSION ARE IN METERS.
 STP INLET LINE 
 STP OUTLET LINE 

SCALE : 1 = 500 REV: R0 DATE:- 28-10-2022

SURVEYOR
KARUNAKARAN ASSOCIATES
 Land Survey & Related Services
 PLOT 12A
 183/3L, T.H. ROAD
 TONDAIYARPET
 CHENNAI - 600 081
 PH: 2591 0810.
 MOBILE: 98400 76561

Er. T. RAMAKRISHNAN,
 B.E.(Civil), M.E. (Structures)
 Licenced Surveyor Class -I No: 2069
 Corporation Of Chennai
 378-A, East Main Road,
 Anna Nagar Western Extn,
 Chennai-600101

 PRINCIPAL
 SRI VENKATESWARA DENTAL COLLEGE & HOSPITAL
 OFF. OMR NEAR - NAVAJUR
 THALAMBUR, CHENNAI-600 130.